

Tous droits strictement réservés. Reproduction ou communication a des tiers interdite sous quelque forme que ce soit sans autorisation écrite du propriétaire. Propriété de c FCI. Droits de reproduction FCI.

All rights strictly reserved. Reproduction or issue to third parties in any form whatever is not permitted without written authority from the proprietor. Property of FCI. Copyright FCI.

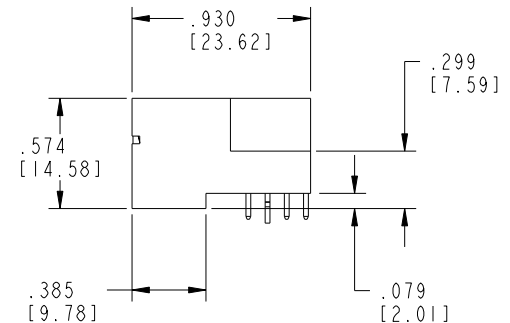
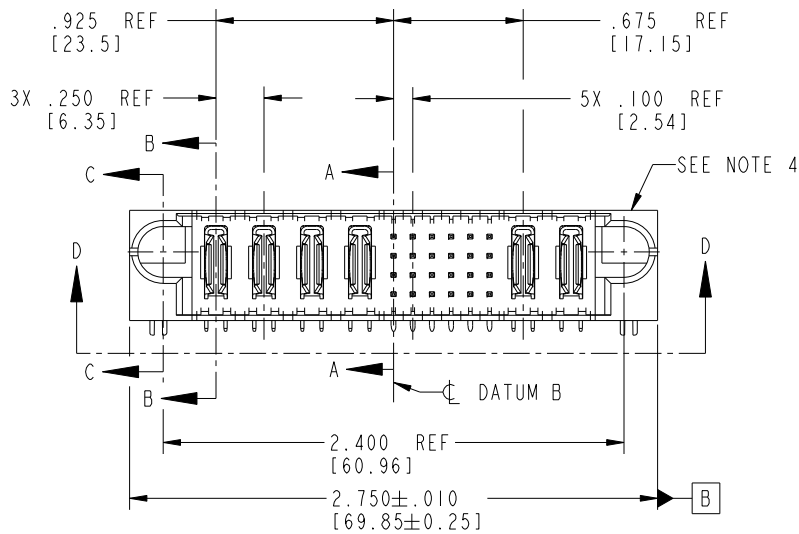
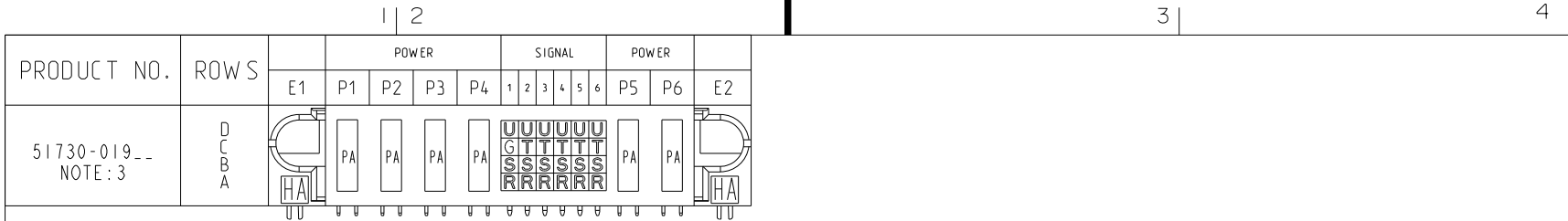

CODE	DIM "M" MATING LENGTH	CONTACT TYPE
G	.220 [5.59]	SIGNAL
R	.270 [6.86]	SIGNAL
S	.270 [6.86]	SIGNAL
T	.270 [6.86]	SIGNAL
U	.270 [6.86]	SIGNAL
PA	N/A [N/A]	POWER
HA	N/A [N/A]	HOLD-DOWN

mat'l code				SEE NOTE 2		tolerances unless otherwise specified		CUSTOMER		FCI	
ltr	ecn no.	dr	date	linear	.XX±.01/0.X±0.3	projection		COPY		www.fciconnect.com	
A	V02900	CGD	12/4/00		.XXX±.005/0.XX±0.13	INCH/MM		title		4P + 24S + 2P	
B	V20150	JWS	01-22-02	angles	.XXX±.0020/0.XXX±0.051	1:1		RIGHT ANGLE SOLDER HEADER		product family	
C	DG05-0386	CS	10/12/05		0° ± 2°	scale		PwrBlade		code	
D	DG05-0560	CS	12/26/05	dr	J. SHAFER 01-22-02	A		51730-019		213	
E	DG08-0272	WD	09/29/08	engr	M. MOSTOLLER 01-22-02	1:1		size		sheet	
				chr	M. MOSTOLLER 01-22-02			dwg no		1 of 4	
				appd	M. MOSTOLLER 01-22-02			A			
sheet index	revision sheet	E	E	E	E						
		1	2	3	4						

Tous droits strictement réservés. Reproduction ou communication a des tiers interdite sous quelque forme que ce soit sans autorisation écrite du propriétaire. Propriété de c FCI. Droits de reproduction FCI.

All rights strictly reserved. Reproduction or issue to third parties in any form whatever is not permitted without written authority from the proprietor. Property of FCI. Copyright FCI.



PRODUCT NUMBER
51730-019--
NOTE:3

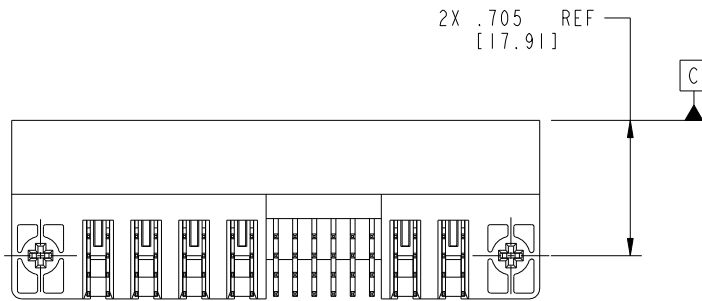

VIEW D-D

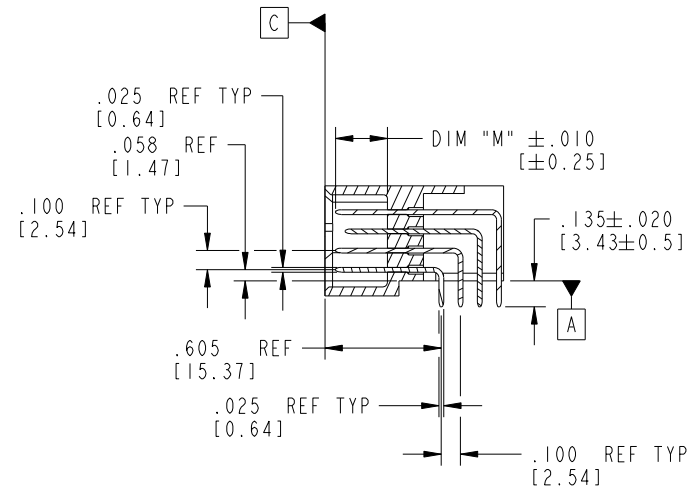

SECTION A-A

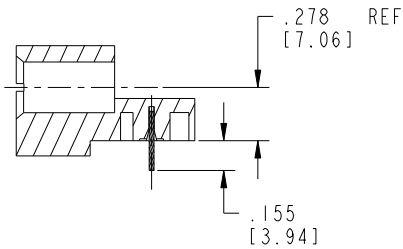

SECTION C-C

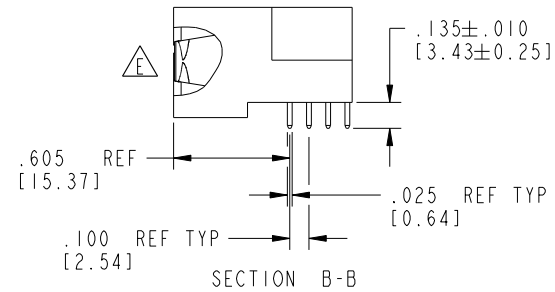

SECTION B-B

mat'l code		SEE NOTE 2		tolerances unless otherwise specified		CUSTOMER		 www.fciconnect.com	
ltr	ecn no.	dr	date	linear	.XX±.01/0.X±0.3	projection	title		
E					.XXY±.005/0.XX±0.13		4P + 24S + 2P		
				angles	.XXX±.0020/0.XXX±0.051		RIGHT ANGLE SOLDER HEADER		
				dr	J. SHAFFER 01-22-02	INCH/MM	product family	PwrBlade	code
				engr	M. MOSTOLLER 01-22-02	scale	size	dwg no	213
				chr	M. MOSTOLLER 01-22-02	1:1	A	51730-019	sheet
				appd	M. MOSTOLLER 01-22-02				2 of 4
sheet index	revision sheet								

Pro/E

PDM: Rev: E

STATUS: Released

Printed: Oct 17, 2008

Tous droits strictement réservés. Reproduction ou communication a des tiers interdite sous quelque forme que ce soit sans autorisation écrite du propriétaire. Propriété de c FCI. Droits de reproduction FCI.



All rights strictly reserved. Reproduction or issue to third parties in any form whatever is not permitted without written authority from the proprietor. Property of FCI. Copyright FCI.

PRODUCT NUMBER
51730-019--
NOTE:3

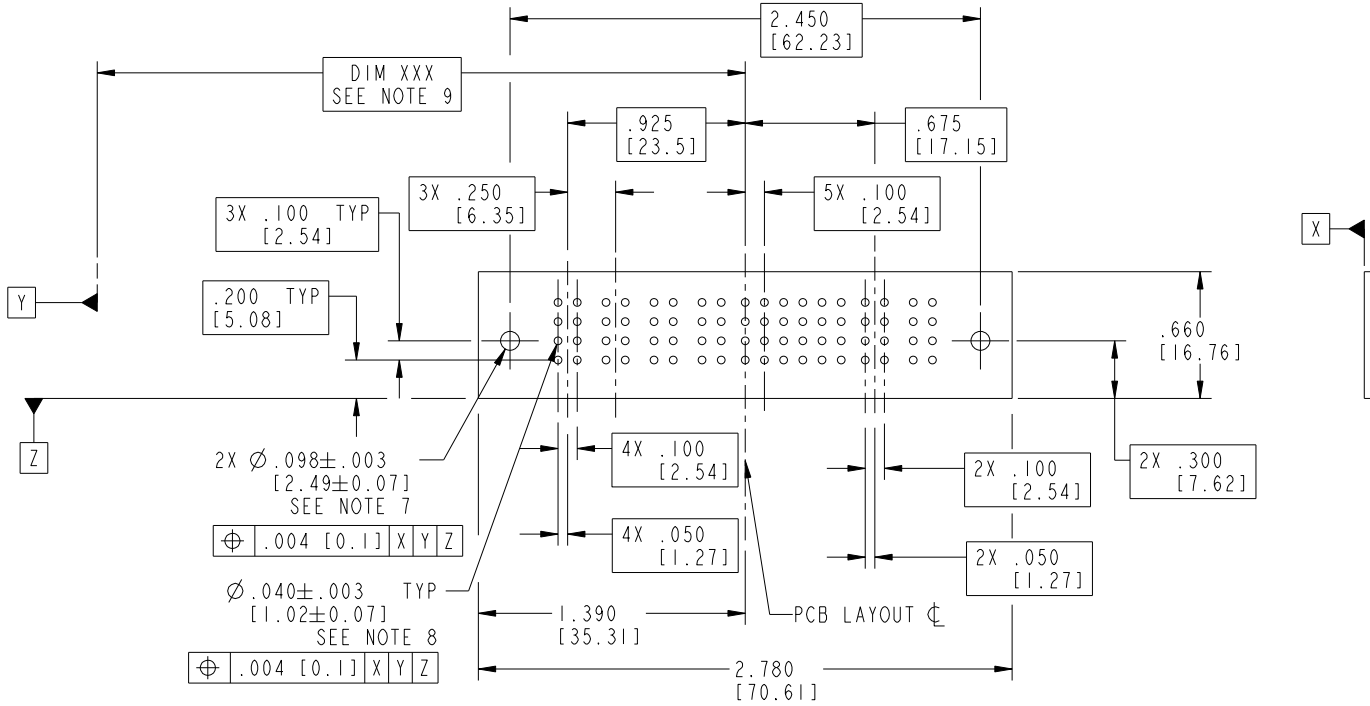

RECOMMENDED PCB LAYOUT

mat'l code		SEE NOTE 2		tolerances unless otherwise specified		CUSTOMER		 www.fciconnect.com	
ltr	ecn no.	dr	date	linear	.XX±.01/0.X±0.3	COPY		title	
E				angles	.XXX±.005/0.XX±0.13	projection		4P + 24S + 2P	
					.XXX±.0020/0.XXX±0.051			RIGHT ANGLE SOLDER HEADER	
				dr	J. SHAFFER 01-22-02	INCH/MM		product family	
				engr	M. MOSTOLLER 01-22-02	scale		PwrBlade	
				chr	M. MOSTOLLER 01-22-02	1:1		code	
				appd	M. MOSTOLLER 01-22-02	A		213	
sheet index		revision sheet				size		sheet	
						A		3 of 4	
						51730-019			

code code 22526

Pro/E

PDM: Rev: E

STATUS: Released

Printed: Oct 17, 2008



1 | 2

3 |

4

PRODUCT NUMBER
51730-019--
NOTE: 3

NOTES:

1. DIMENSIONS AND TOLERANCES ARE IN ACCORDANCE WITH ASME Y14.5M, 1994 UNLESS OTHERWISE SPECIFIED.

CONNECTORS NOTES:

② HOUSING MATERIAL: UL 94 V-0 GLASS FILLED HIGH TEMP THERMO PLASTIC
POWER CONTACT MATERIAL: COPPER ALLOY
SIGNAL PIN MATERIAL: COPPER ALLOY

③ SEE ITEM 1 & 2 IN PRINT 10064183 FOR PLATING SPEC OF 51730-019 AND 51730-019LF RESPECTIVELY.

4. "MANUFACTURER" NAME, P/N, AND DATE CODE TO APPEAR ON THIS SURFACE.

5. PRODUCT SPECIFICATION GS-12-149.

PCB - NOTES:

6. ALL HOLE DIAMETERS ARE FINISHED HOLE SIZE.

⑦ HOLD DOWN THROUGH HOLES ARE UNPLATED.

⑧ $\varnothing .0453 \pm 0.0010$ [1.151 \pm 0.025] DRILLED HOLES PLATED WITH 0.0003 [0.008] MIN SnPb OVER .001 [0.03] TO .003 [0.08] Cu PLATING TO ACHIEVE $\varnothing .040 \pm .003$ [1.02 \pm .07] HOLE.

⑨ "DIM XXX" TO BE DETERMINED BY THE CUSTOMER.

10. A \triangle SYMBOL WILL BE NEXT TO ANY DIMENSION, VIEW, OR NOTE WHICH HAS BEEN MODIFIED WITH THE CURRENT DRAWING REVISION.

mat'l code		SEE NOTE 2		tolerances unless otherwise specified		CUSTOMER		FCI		www.fciconnect.com	
ltr	ecn no.	dr	date	linear	.XX±.01/0.X±0.3	COPY		projection		title	
E					.XXX±.005/0.XX±0.13	INCH/MM		RIGHT ANGLE		4P + 24S + 2P	
				angles	.XXX±.0020/0.XXX±0.051	1:1		product family		code	
				dr	0° ± 2°	scale		PwrBlade		213	
				engr	J. SHAFFER 01-22-02	A		size		sheet	
				chr	M. MOSTOLLER 01-22-02	51730-019		dwg no		4 of 4	
				appd	M. MOSTOLLER 01-22-02						
sheet index	revision sheet										

1 | 2

Pro/E

PDM: Rev: E

STATUS: Released

Printed: Oct 17, 2008